

Installation plan:

PG 8592 – PG 8593

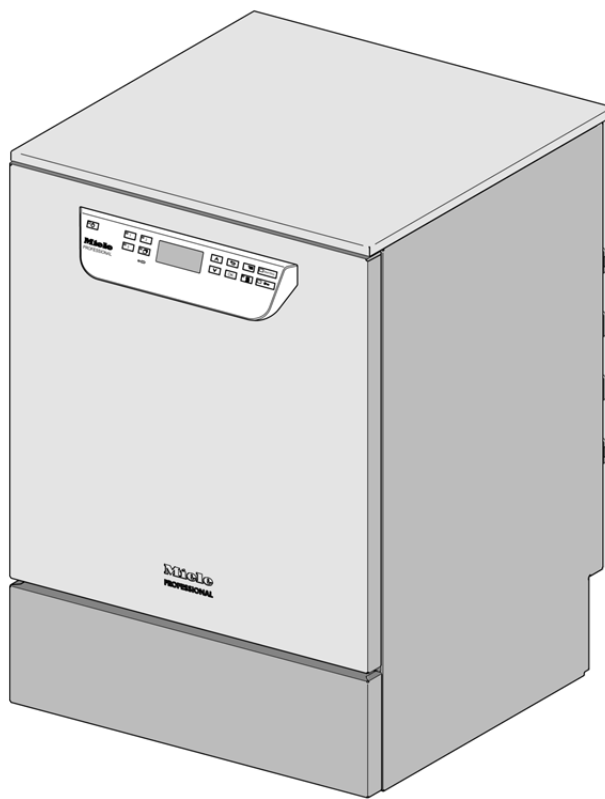

**Mat. no.
Version**

**10 344 170
00
US**

Legend:





Circled, bold-type abbreviations:
Connection required





Abbreviations surrounded by broken circle:
Connection optional or required, depending on model

PG 8592:

 Electrical connection PG 8592	Voltage (default)	2 AC 208V 60 Hz	2 AC 208V 60 Hz
	Rated load	6.2 kW	6.2 kW
	Fuse rating	2 pole 30 Amp	2 pole 30 Amp
	Minimum cross-section	3 x AWG 10	3 x 5.2 mm ²
	Length of electrical cord (UL 921) with plug	approx. 5' 9"	approx. 1.8 m
	Electrical connection	NEMA L6-30	NEMA L6-30
 Electrical connection PG 8592	Voltage (convertible)	3 AC 208V 60 Hz	3 AC 208V 60 Hz
	Rated load	6.2 kW	6.2 kW
	Fuse rating	3 pole 20 Amp	3 pole 20 Amp
	Minimum cross-section	4 x AWG 12	4 x 3.3 mm ²
	Length of electrical cord (UL 921) with plug	approx. 5' 9"	approx. 1.8 m
	Electrical connection	NEMA L15-20	NEMA L15-20

PG 8593:





 Electrical connection PG 8593	Voltage (default)	3 AC 208V 60 Hz	3 AC 208V 60 Hz
	Rated load	6.2 kW	6.2 kW
	Fuse rating	3 pole 20 Amp	3 pole 20 Amp
	Minimum cross-section	4 x AWG 12	4 x 3.3 mm ²
	Length of electrical cord (UL 921) with plug	approx. 5' 9"	approx. 1.8 m
	Electrical connection	NEMA L15-20	NEMA L15-20
 Electrical connection PG 8593	Voltage (convertible)	2 AC 208V 60 Hz	2 AC 208V 60 Hz
	Rated load	6.2 kW	6.2 kW
	Fuse rating	2 pole 30 Amp	2 pole 30 Amp
	Minimum cross-section	3 x AWG 10	3 x 5.2 mm ²
	Length of electrical cord (UL 921) with plug	approx. 5' 9"	approx. 1.8 m
	Electrical connection	NEMA L6-30	NEMA L6-30

Connection to the electrical supply must be carried out in accordance with local and national safety regulations. The power cord must be protected from the risk of thermal damage.

It is recommended to make an electrical connection via a plug and socket so that electrical safety checks can be carried out easily. The socket must be accessible after machine installation.

For hard-wired machines, a main switch must be provided on site, which must completely isolate the machine from the power supply with a contact gap of at least 1/8" (3 mm).

The plug and socket as well as the main switch must be easily accessible after the machine has been installed.

	<p>Equipotential bonding and grounding</p>	<p>For added safety the machine should be protected with a residual current device with a trip current of 30 mA.</p> <p>If necessary, an equipotential bond with good contact connection must be provided in accordance with all appropriate national and local regulations.</p> <p>Equipotential bonding and grounding must be completed before the machine is commissioned.</p> <p>There is a screw connection point at the back of the washer-disinfector, to which equipotential bonding can be connected.</p>																																					
	<p>Communication modules (optional)</p>	<p>Optional ethernet and RS232 communication modules are available. They are not supplied with the machine. The fuse box for the modules should be installed near the machine for transferring and printing process data. They must be installed and connected in accordance with local codes and standards.</p>																																					
	<p>Cold Water Connections (machine comes with two cold water connections)</p>	<p>Use supplied Y-adapter if only one cold water connection is available.</p> <table border="1" data-bbox="456 555 1402 1032"> <tr> <td>Max. temperature</td> <td>68 °F</td> <td>20 °C</td> </tr> <tr> <td>Max. water hardness</td> <td>73 gpg</td> <td>70 °dH</td> </tr> <tr> <td>Recommended flow pressure</td> <td>29 psi</td> <td>200 kPa</td> </tr> <tr> <td>Min. flow pressure with extended water intake</td> <td>14.5 psi</td> <td>100 kPa</td> </tr> <tr> <td>Max. pressure</td> <td>145 psi</td> <td>1,000 kPa</td> </tr> <tr> <td>Throughput</td> <td>2 gal/min</td> <td>7.5 l/min</td> </tr> <tr> <td>Connection thread - on site (flat sealing)</td> <td>3/4" Male Garden Hose Thread</td> <td>3/4" Male Garden Hose Thread</td> </tr> <tr> <td>Length of connection hose (supplied)</td> <td>approx. 5' 7"</td> <td>approx. 1.7 m</td> </tr> <tr> <td>Length of the steam condenser hose</td> <td>approx. 5' 7"</td> <td>approx. 1.7 m</td> </tr> </table>		Max. temperature	68 °F	20 °C	Max. water hardness	73 gpg	70 °dH	Recommended flow pressure	29 psi	200 kPa	Min. flow pressure with extended water intake	14.5 psi	100 kPa	Max. pressure	145 psi	1,000 kPa	Throughput	2 gal/min	7.5 l/min	Connection thread - on site (flat sealing)	3/4" Male Garden Hose Thread	3/4" Male Garden Hose Thread	Length of connection hose (supplied)	approx. 5' 7"	approx. 1.7 m	Length of the steam condenser hose	approx. 5' 7"	approx. 1.7 m									
Max. temperature	68 °F	20 °C																																					
Max. water hardness	73 gpg	70 °dH																																					
Recommended flow pressure	29 psi	200 kPa																																					
Min. flow pressure with extended water intake	14.5 psi	100 kPa																																					
Max. pressure	145 psi	1,000 kPa																																					
Throughput	2 gal/min	7.5 l/min																																					
Connection thread - on site (flat sealing)	3/4" Male Garden Hose Thread	3/4" Male Garden Hose Thread																																					
Length of connection hose (supplied)	approx. 5' 7"	approx. 1.7 m																																					
Length of the steam condenser hose	approx. 5' 7"	approx. 1.7 m																																					
	<p>Hot Water Connection</p>	<table border="1" data-bbox="456 1032 1402 1458"> <tr> <td>Max. temperature</td> <td>150 °F</td> <td>65 °C</td> </tr> <tr> <td>Max. water hardness</td> <td>73 gpg</td> <td>70 °dH</td> </tr> <tr> <td>Recommended flow pressure</td> <td>29 psi</td> <td>200 kPa</td> </tr> <tr> <td>Min. flow pressure with extended water intake</td> <td>5.8 psi</td> <td>40 kPa</td> </tr> <tr> <td>Max. pressure</td> <td>145 psi</td> <td>1,000 kPa</td> </tr> <tr> <td>Throughput</td> <td>2 gal/min</td> <td>7.5 l/min</td> </tr> <tr> <td>Connection thread - on site (flat sealing)</td> <td>3/4" Male Garden Hose Thread</td> <td>3/4" Male Garden Hose Thread</td> </tr> <tr> <td>Length of connection hose (supplied)</td> <td>approx. 5' 7"</td> <td>approx. 1.7 m</td> </tr> </table>		Max. temperature	150 °F	65 °C	Max. water hardness	73 gpg	70 °dH	Recommended flow pressure	29 psi	200 kPa	Min. flow pressure with extended water intake	5.8 psi	40 kPa	Max. pressure	145 psi	1,000 kPa	Throughput	2 gal/min	7.5 l/min	Connection thread - on site (flat sealing)	3/4" Male Garden Hose Thread	3/4" Male Garden Hose Thread	Length of connection hose (supplied)	approx. 5' 7"	approx. 1.7 m												
Max. temperature	150 °F	65 °C																																					
Max. water hardness	73 gpg	70 °dH																																					
Recommended flow pressure	29 psi	200 kPa																																					
Min. flow pressure with extended water intake	5.8 psi	40 kPa																																					
Max. pressure	145 psi	1,000 kPa																																					
Throughput	2 gal/min	7.5 l/min																																					
Connection thread - on site (flat sealing)	3/4" Male Garden Hose Thread	3/4" Male Garden Hose Thread																																					
Length of connection hose (supplied)	approx. 5' 7"	approx. 1.7 m																																					
	<p>Demineralized water</p>	<table border="1" data-bbox="456 1458 1402 2078"> <tr> <td>Max. temperature</td> <td>150 °F</td> <td>65 °C</td> </tr> <tr> <td>Recommended flow pressure</td> <td>29 psi</td> <td>200 kPa</td> </tr> <tr> <td>Min. flow pressure with extended water intake</td> <td>4.4 psi</td> <td>30 kPa</td> </tr> <tr> <td>Max. pressure</td> <td>145 psi</td> <td>1,000 kPa</td> </tr> <tr> <td>Connection thread - on site (flat sealing)</td> <td>3/4" Male Garden Hose Thread</td> <td>3/4" Male Garden Hose Thread</td> </tr> <tr> <td>Throughput</td> <td>2 gal/min</td> <td>7.5 l/min</td> </tr> <tr> <td>Length of connection hose (supplied)</td> <td>approx. 5' 7"</td> <td>approx. 1.7 m</td> </tr> <tr> <td colspan="3">Requirements for unpressurized demineralized water system:</td> </tr> <tr> <td>Minimum flow pressure (DI unpressurized)</td> <td>1.3 psi</td> <td>8.5 kPa</td> </tr> <tr> <td>Maximum pressure (DI unpressurized)</td> <td>8.7 psi</td> <td>60 kPa</td> </tr> <tr> <td>Machine connection nipple (outer dia. x l)</td> <td>1/4" x 3/16"</td> <td>6 mm x 30 mm</td> </tr> <tr> <td colspan="3">Hose from supply container to machine to be installed on site.</td> </tr> </table>		Max. temperature	150 °F	65 °C	Recommended flow pressure	29 psi	200 kPa	Min. flow pressure with extended water intake	4.4 psi	30 kPa	Max. pressure	145 psi	1,000 kPa	Connection thread - on site (flat sealing)	3/4" Male Garden Hose Thread	3/4" Male Garden Hose Thread	Throughput	2 gal/min	7.5 l/min	Length of connection hose (supplied)	approx. 5' 7"	approx. 1.7 m	Requirements for unpressurized demineralized water system:			Minimum flow pressure (DI unpressurized)	1.3 psi	8.5 kPa	Maximum pressure (DI unpressurized)	8.7 psi	60 kPa	Machine connection nipple (outer dia. x l)	1/4" x 3/16"	6 mm x 30 mm	Hose from supply container to machine to be installed on site.		
Max. temperature	150 °F	65 °C																																					
Recommended flow pressure	29 psi	200 kPa																																					
Min. flow pressure with extended water intake	4.4 psi	30 kPa																																					
Max. pressure	145 psi	1,000 kPa																																					
Connection thread - on site (flat sealing)	3/4" Male Garden Hose Thread	3/4" Male Garden Hose Thread																																					
Throughput	2 gal/min	7.5 l/min																																					
Length of connection hose (supplied)	approx. 5' 7"	approx. 1.7 m																																					
Requirements for unpressurized demineralized water system:																																							
Minimum flow pressure (DI unpressurized)	1.3 psi	8.5 kPa																																					
Maximum pressure (DI unpressurized)	8.7 psi	60 kPa																																					
Machine connection nipple (outer dia. x l)	1/4" x 3/16"	6 mm x 30 mm																																					
Hose from supply container to machine to be installed on site.																																							

AW	Drain Water	Drainage temperature	200 °F	93 °C	
		Length of drain hose	approx. 4' 6"	approx. 1.4 m	
		Drain hose, max. drainage length	approx. 13' 1"	approx. 4.0 m	
		Drain pump head height from floor level, max.	approx. 3' 3"	approx. 1 m	
		Drain hose delivery, max.	4.2 gal/min	16 l/min	
		On-site hose connector (external diameter x length)	7/8" x 1 3/16"	22 mm x 30 mm	
		It is advisable to lay the drain hose in a curve min. 23 5/8" (600 mm) above floor level to the drainage point.			
DS	External dispensing (optional) (note machine model)	Connection for up to two dispensing units for liquid agents on the back panel.			
	Machine feet	Height-adjustable	0-2 3/8"	0-60 mm	
		Foot diameter	1 3/8"	35 mm	
		Entry point into housing	8 M	8 M	
	Heat Dissipation to Room	Heat transfer by emission	1,194 btu/h	0.35 kWh/h	
		Load on removal	1,365 btu/h	0.40 kWh/h	
	Machine data	Height	32 7/8"	835 mm	
		Height without lid	32 5/16"	820 mm	
		Width	23 5/8"	600 mm	
		Width without lid	23 9/16"	598 mm	
		Depth	23 5/8"	600 mm	
		Depth without lid	23 9/16"	598 mm	
		Door height	24 1/2"	622 mm	
		Net weight	172 lbs	78 kg	
		Dynamic floor load	1,200 N	1,200 N	
		Width including transport pallet	26 3/8"	670 mm	
		Depth including transport pallet	29 3/8"	740 mm	
		Height including transport pallet	36 1/4"	920 mm	
		Sound emissions in dB (A), Sound pressure LpA, washing and drying		< 70 dB	< 70 dB
			Set-up Conditions	Ambient temperature	40-105 °F
Max. humidity	80%			80%	
Rel. humidity, declining proportionally up to 104°F (40°C)	50%			50%	
Max. altitude above sea level	4,921'			1,500 m	
Please read and observe the instructions in the operating instruction manual and the service documents regarding installation and setting up of this medical washer/disinfector.					
Installation should only be carried out by authorized installers in accordance with valid regulations, relevant standards and health and safety codes.					
The machine must be commissioned and operators trained in its use by Miele Service or by an approved Miele Service Technician only.					
Condensate can build up in the area surrounding the machine. Any cabinetry and fixtures in the room must be suitable.					
If the machine is installed under a countertop (built-under model), a stainless steel panel must be installed above the door opening to protect the countertop from moisture damage. A suitable stainless steel cover plate is available to order from Miele.					

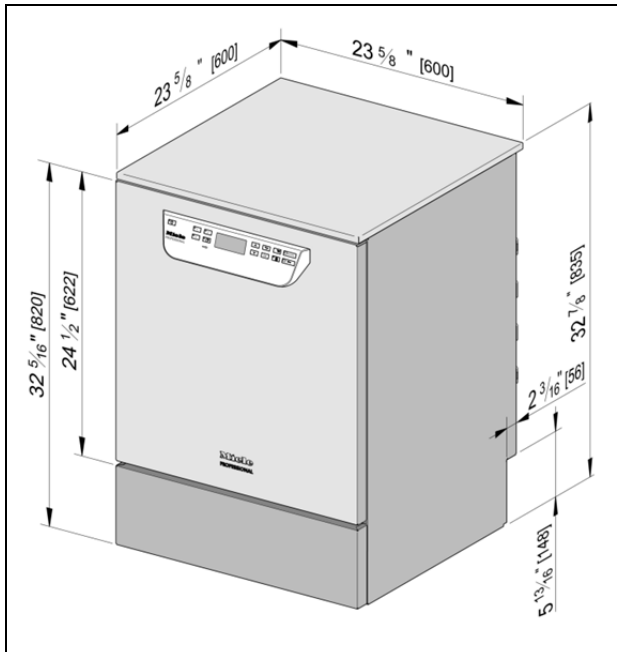

Machine with lid (standard)

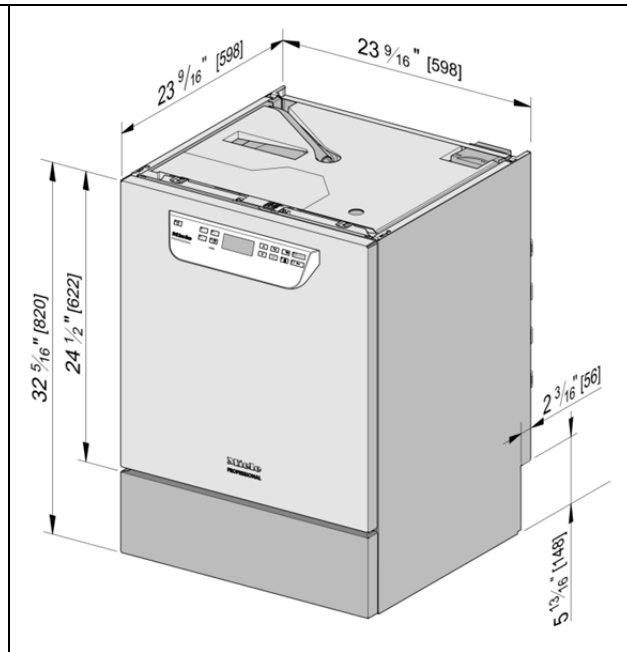

Machine without lid

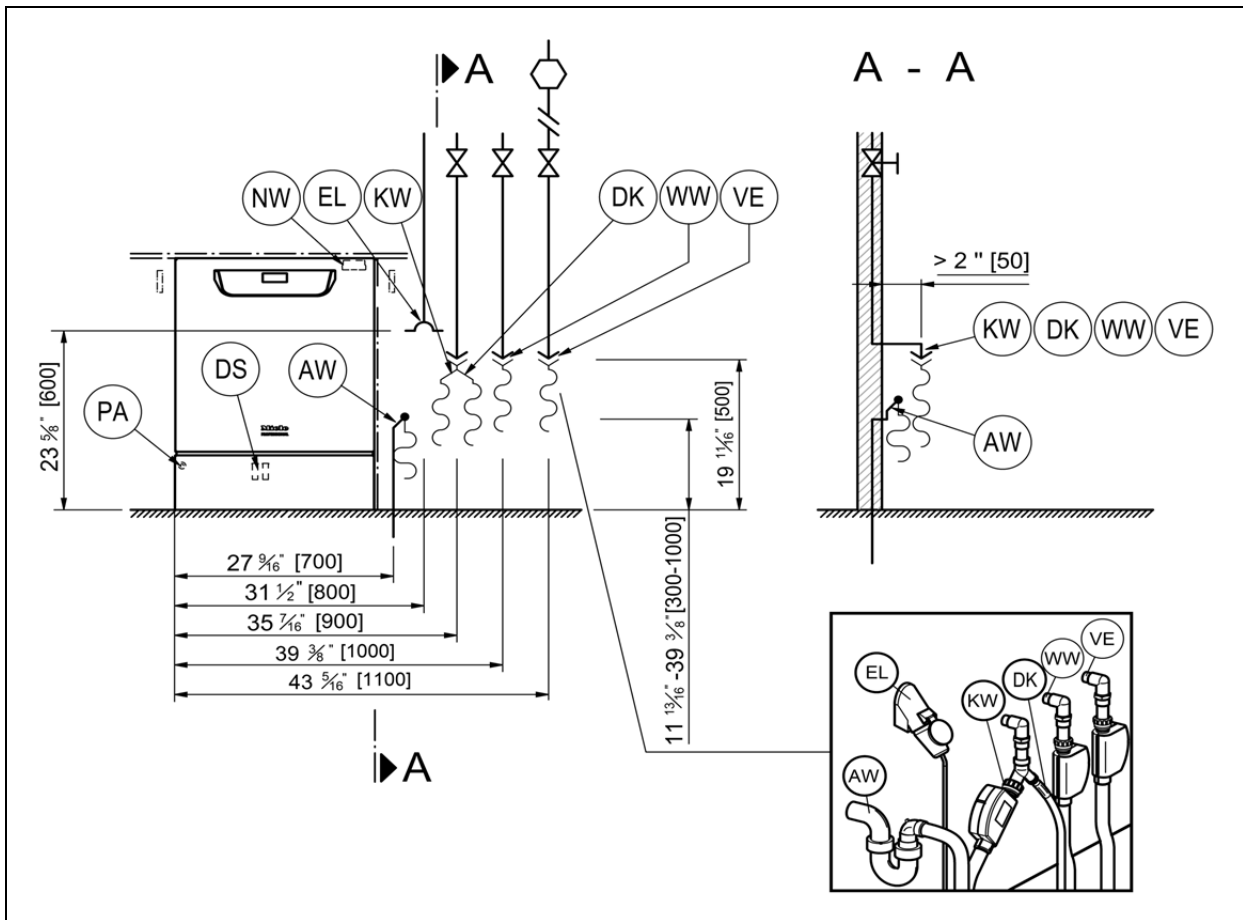

AW	Drain water	NW	Network and printer connection
DK	Cold water connection, steam condenser	PA	Equipotential bonding
DS	External dispensing system connection	VE	Demineralized water connection
EL	Electrical connection	WW	Hot water connection
KW	Cold water connection		

Machine shown without lid

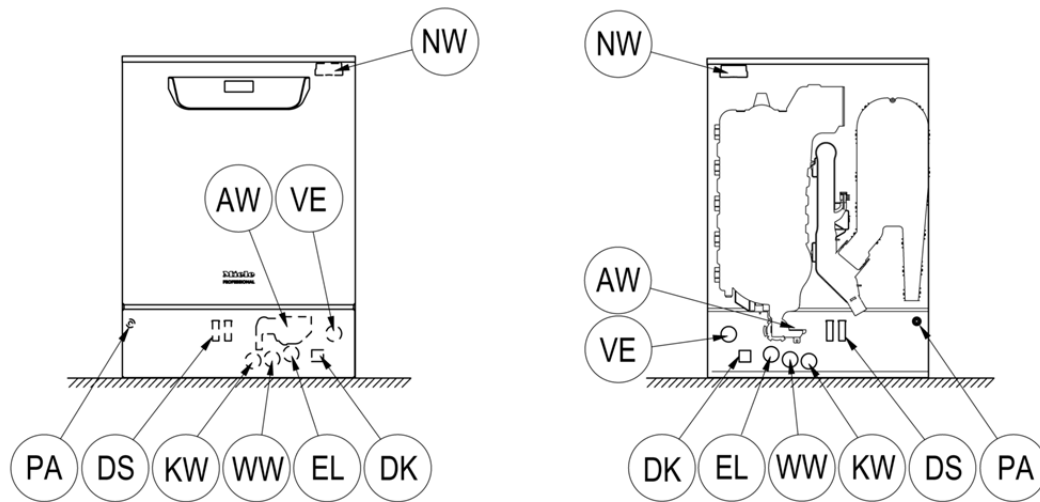
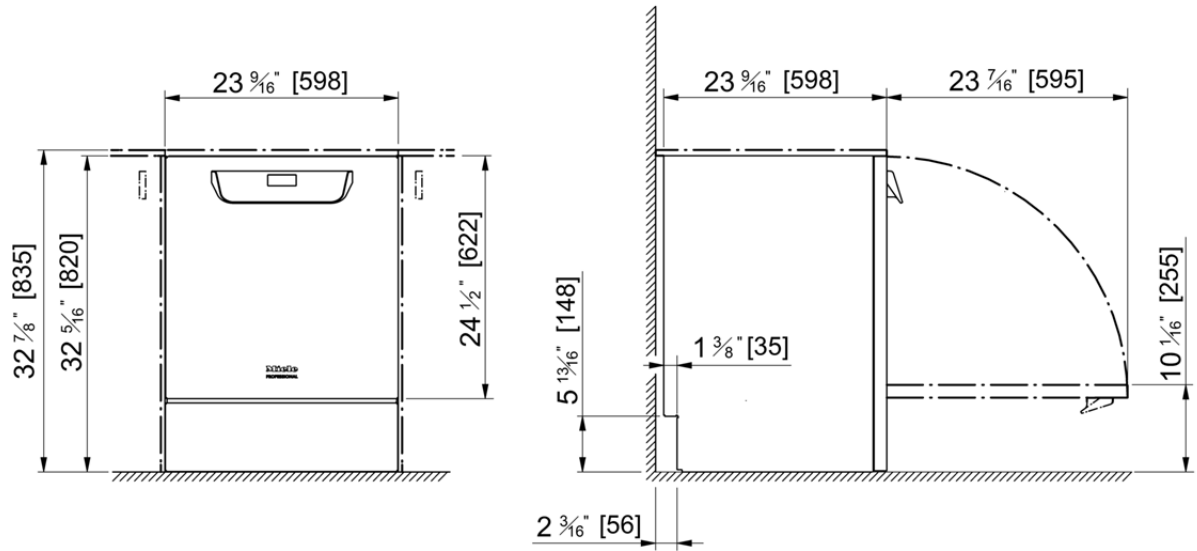

AW	Drain water	NW	Network and printer connection
DK	Cold water connection, steam condenser	PA	Equipotential bonding
DS	External dispensing system connection	VE	Demineralized water connection
EL	Electrical connection	WW	Hot water connection
KW	Cold water connection		